

ABOUT ARMENDUS

Armendus with its years of expertise and professional team designed a variety of Support Arms Systems and Control Panels distinguished by their modern structure, durability, safe and easy usage. All of these are placing Armendus ahead of its competitors in the market.

Armendus Team monitors the production thoroughly from the raw material stage to the final stage. In collaboration with certified laboratories, we implement certain tests and analyzes before putting any product into service. These tests and analysis ensure that our products are in conformity with international standards. All of these steps are applied in order to provide 100% reliable and trusted products to Armendus customers.

Armendus proudly guarantee the quality and the attention given for its whole range of products with Brand Registration Certificate, Utility Model Certificate, Design Registration Certificate, CE and IP Certificates.

5
YEARS
WARRANTY

ISO **CE**
9001:2015

AI **6000**
aluminium **QUALITY**



LOAD DIAGRAM

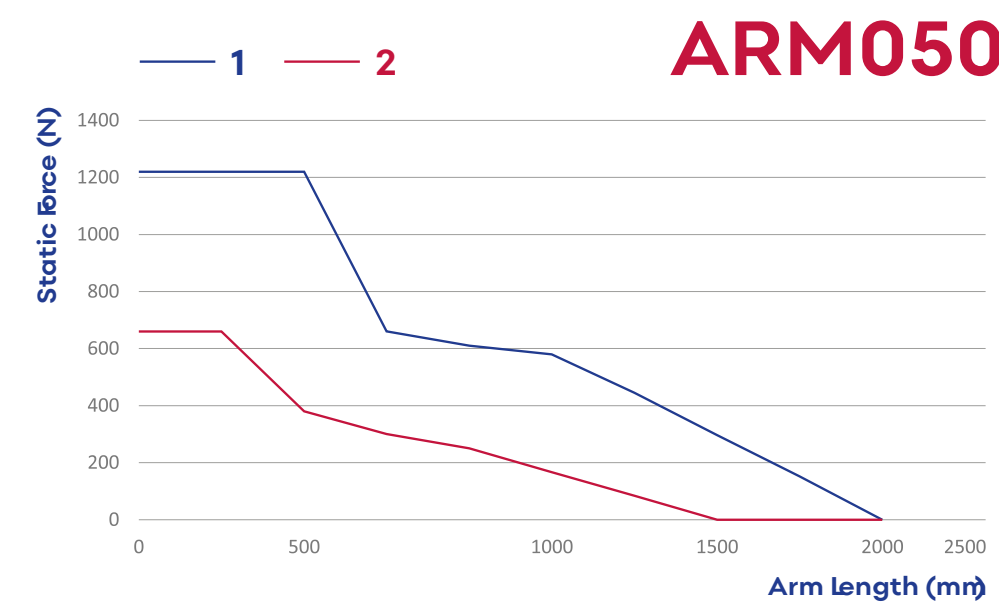
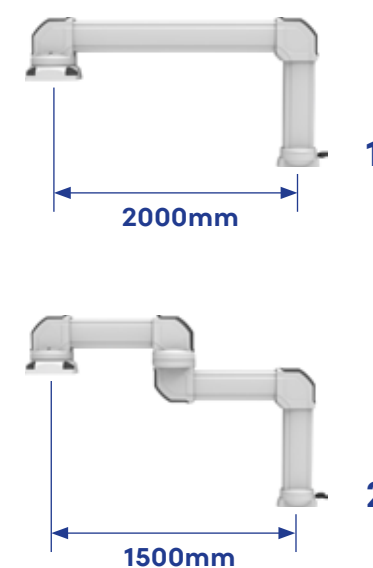
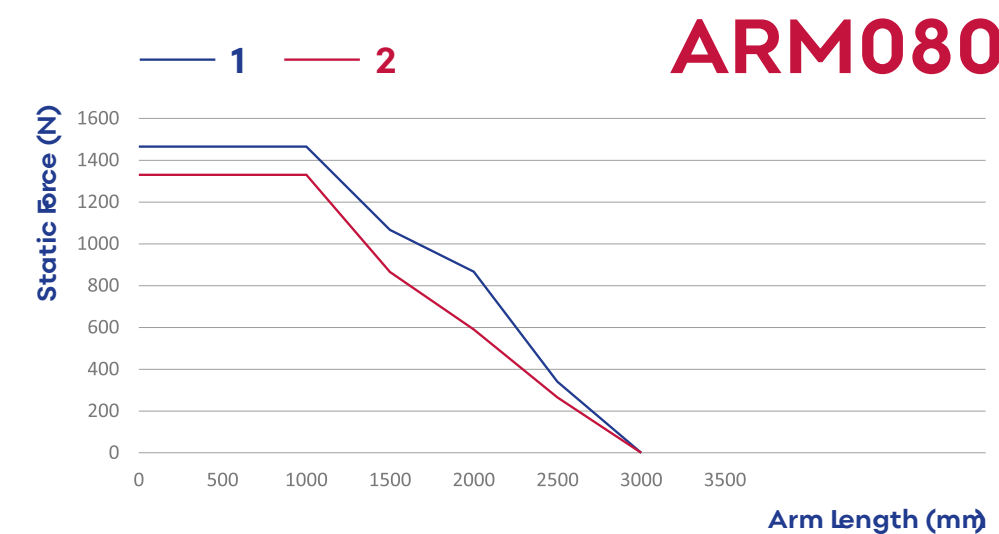
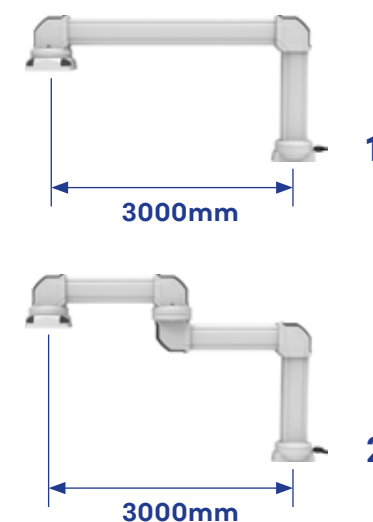
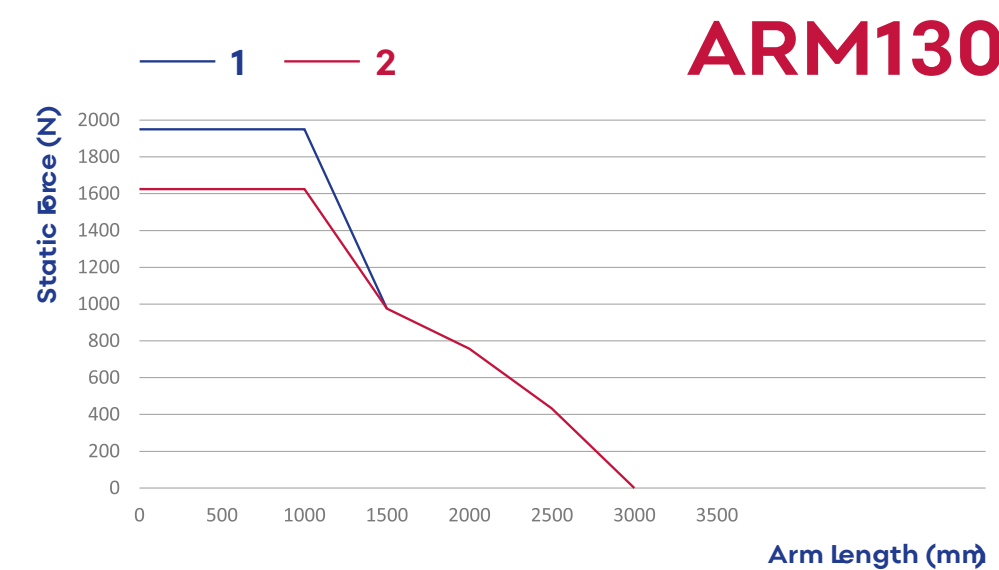
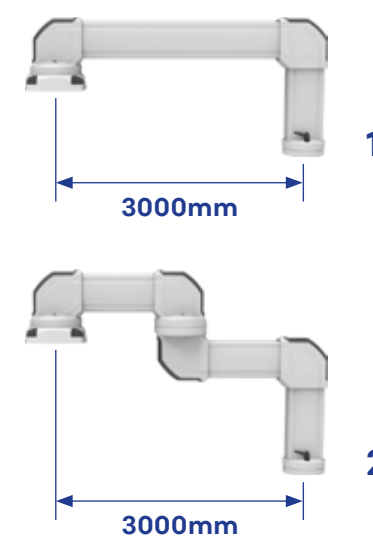
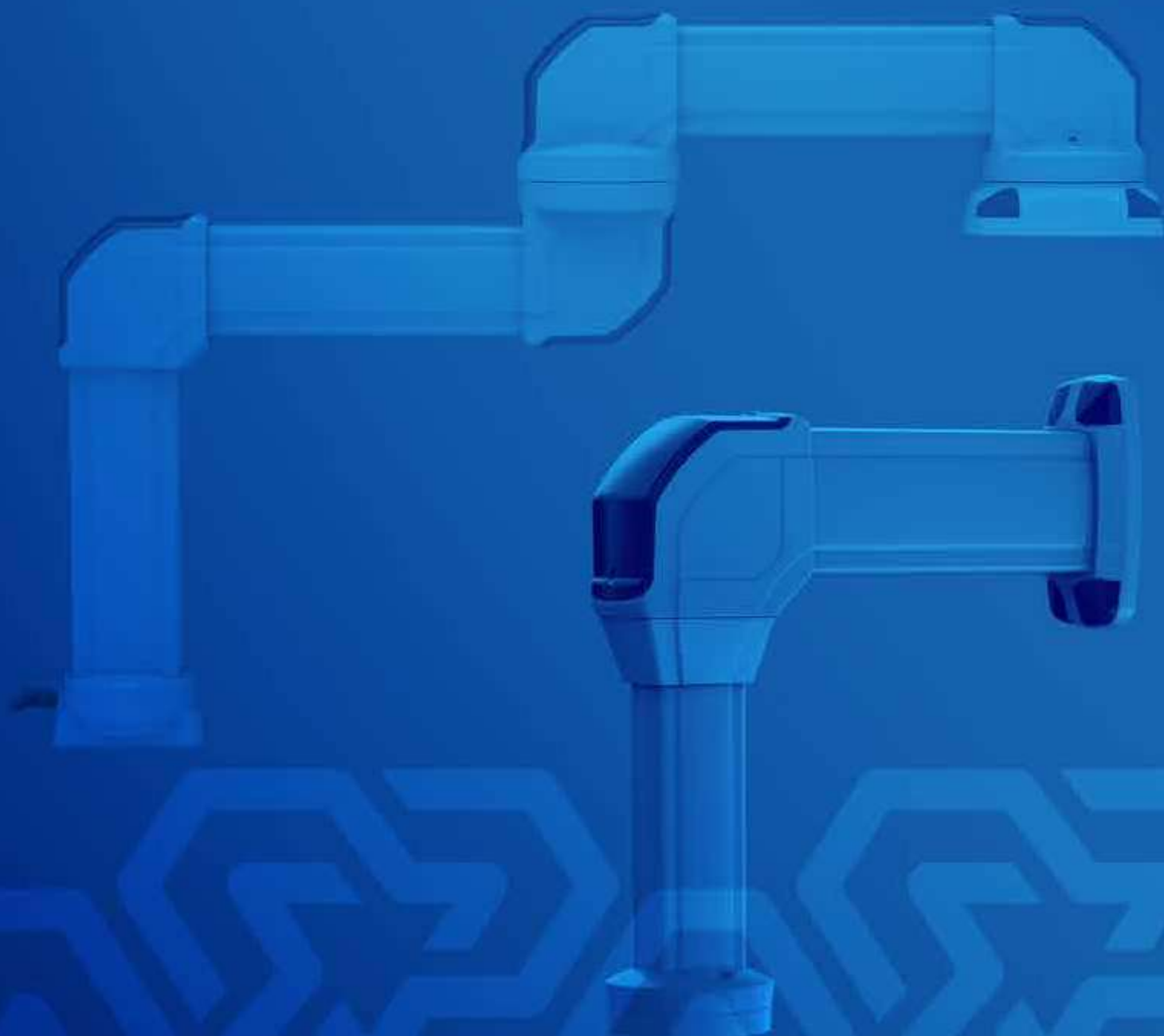

SUPPORT ARM SYSTEMS

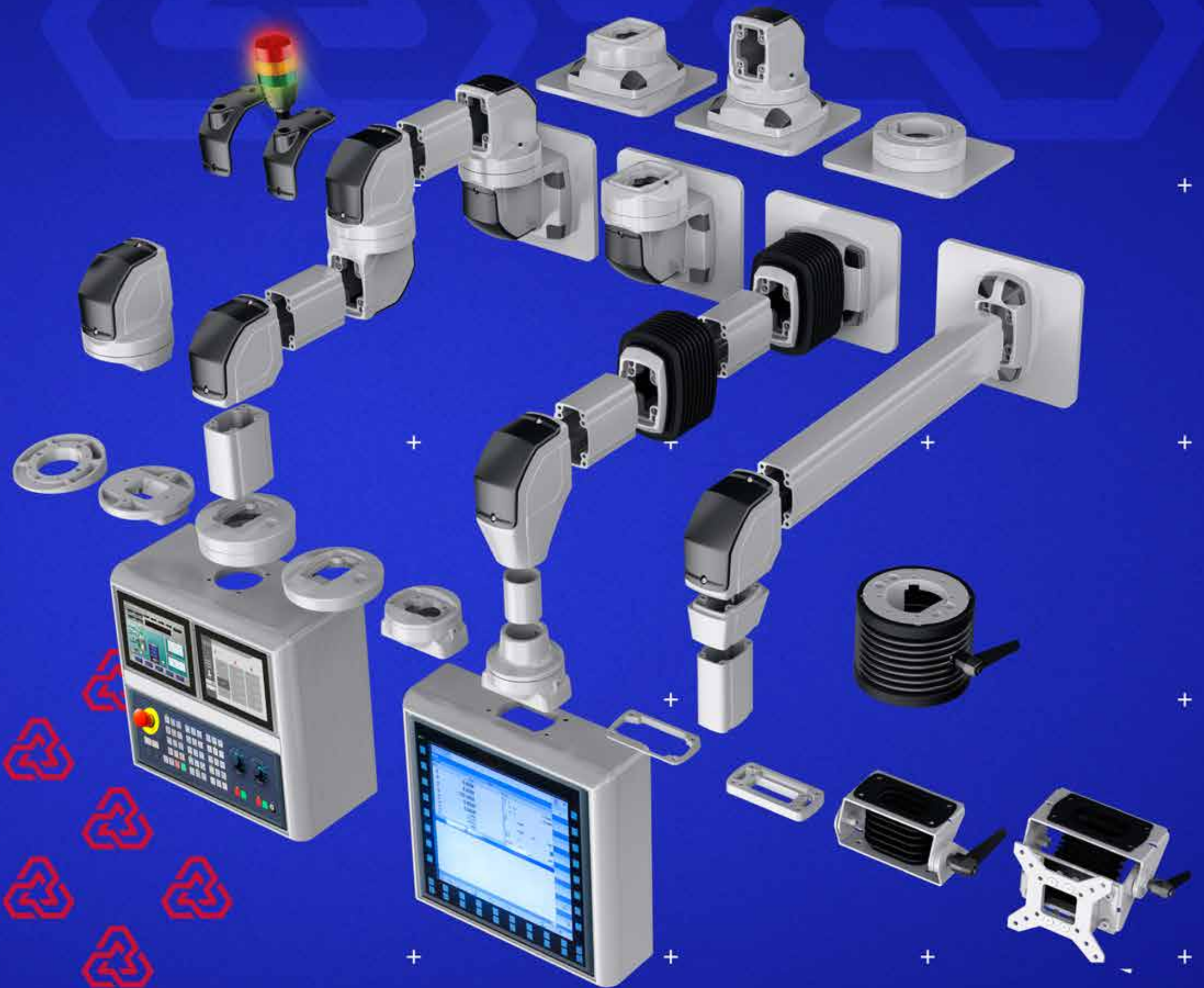

NEW

ARM130.900

Height Adjustable
Support Arm



**HEIGHT
ADJUSTABLE**



NEW

ARM080.900

Height Adjustable
Support Arm



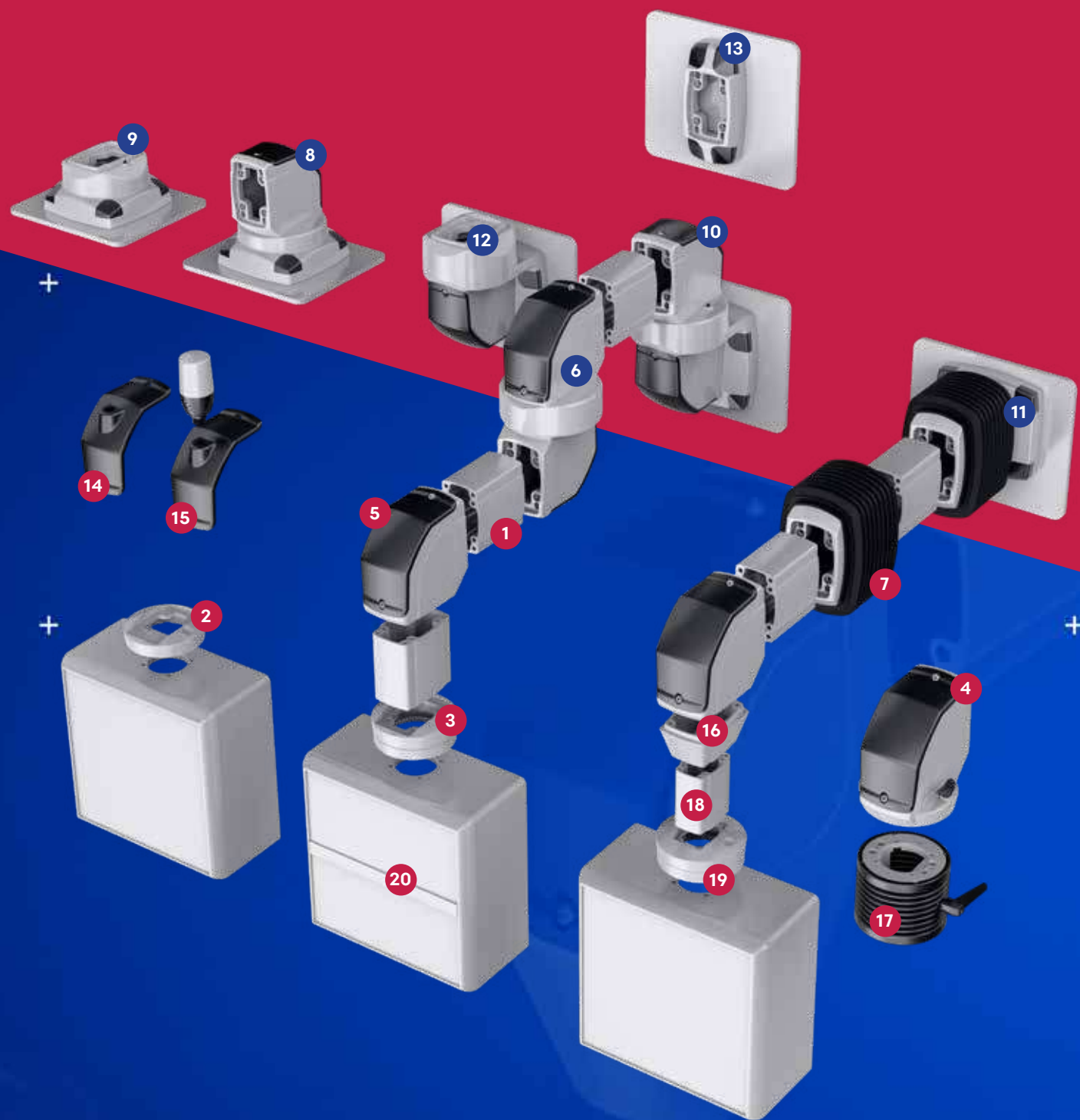

1	ARM130 PROFILE	Support Arm Profile
2	ARM130.310	Panel Coupling
3	ARM130.320	Rotatable Panel Coupling
4	ARM130.400	Rotatable Panel 90°Angle Coupling
5	ARM130.420	90° Angle Piece
6	ARM130.500	Rotatable Intermediate Hinge
7	ARM130.505	Steel Interconnection Module - With Bellows
8	ARM130.600	Rotatable Top Mounted 90° Angle Joint
9	ARM130.610	Rotatable Top Mounted Vertical Outlet
10	ARM130.700	Rotatable Wall-Mounted Hinge Horizontal Outlet
11	ARM130.705	Steel Wall Mounted Module - With Bellows
12	ARM130.710	Rotatable Wall-Mounted Hinge Vertical Outlet
13	ARM130.800	Wall-Socket Mounting Bracket
14	ARM130.810	Warning Lamp Cover (M22)
15	ARM130.811	Warning Lamp Cover (M18)
16	ARM130.820	130/080 Support Arm Adaptor
17	ARM130.840	Ø130 mm Panel Tilting Adaptor - With Bellows
18	ARM080 PROFILE	Support Arm Profile
19	ARM080.320	Rotatable Panel Coupling
20	PRO150 PANEL	PRO150 Enclosure Panel

SUPPORT
ARM SYSTEMS

ARM130

Support Arm Profile

ARM130.025

ARM130.310

Panel Coupling

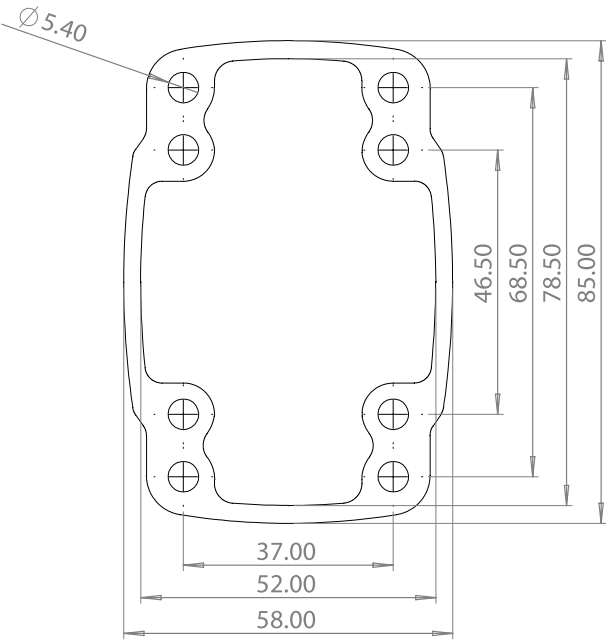

ARM.130 Operator Arm Systems determines the working and movement area of the ARM series. It is produced for big-sized control panels with heavy loads and large dimensions. This product, with its high and modern structural durability is designed with advanced technology and works with other modules at high efficiency, bringing the operator arm to the fore. This operator arm can be produced in any requested length. The load capacity of a 1m long operator arm is up to 130kg. RAL 7035 light gray paint is used for this module with sealing feature.

Model No	Description	Length (mm)	Weight (mm)	Ral Code	Package Dimension
ARM130.025	130 Support Profile - 250mm	250	1625	7035	80 x 130 x 260
ARM130.050	130 Support Profile - 500mm	500	3250	7035	80 x 130 x 510
ARM130.075	130 Support Profile - 750mm	750	4875	7035	80 x 130 x 760
ARM130.100	130 Support Profile - 1000mm	1000	6500	7035	80 x 130 x 1010
ARM130.125	130 Support Profile - 1250mm	1250	8125	7035	80 x 130 x 1260
ARM130.150	130 Support Profile - 1500mm	1500	9750	7035	80 x 130 x 1510
ARM130.175	130 Support Profile - 1750mm	1750	11375	7035	80 x 130 x 1760
ARM130.200	130 Support Profile - 2000mm	2000	13000	7035	80 x 130 x 2010

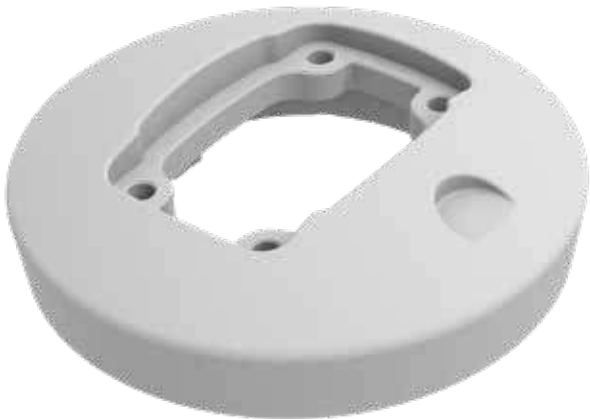

Ø134mm Panel Coupling provides the connection between the operator arm and the operator panel. ARM130.310 is a fixed module. The diameter is 130mm and produced for wide panels with depth.

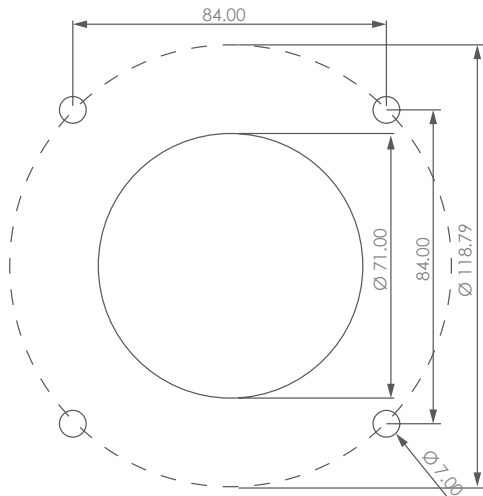
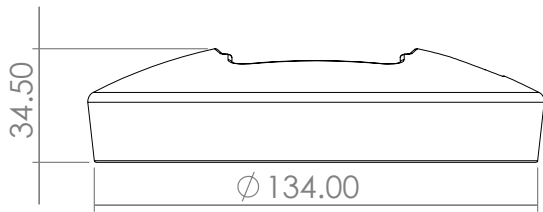
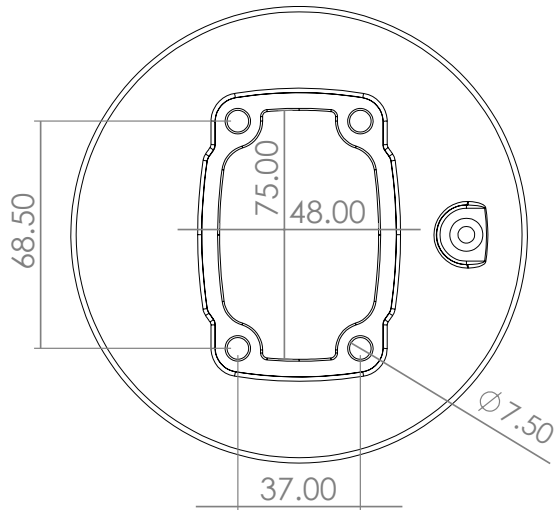

Weight	480 gr
Color Ral No	RAL 7035
Package	1
Package Dimension	135x40x135 mm
Material	Aluminum
Movement	Fixed
Diameter	Ø134 mm

Rotatable Panel Coupling

ARM130.320

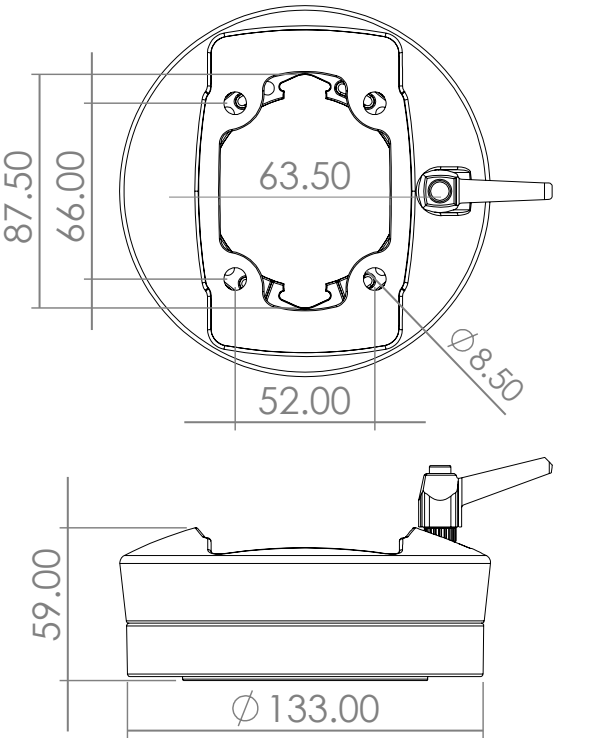

ARM130.320 Rotatable Panel Coupling provides the connection between the operator arm and the operator panel. The diameter is 133mm with a rotation capacity of 315° allowing the operator to rotate the panel to any desired position. It is produced for panel types with high depth ratio.

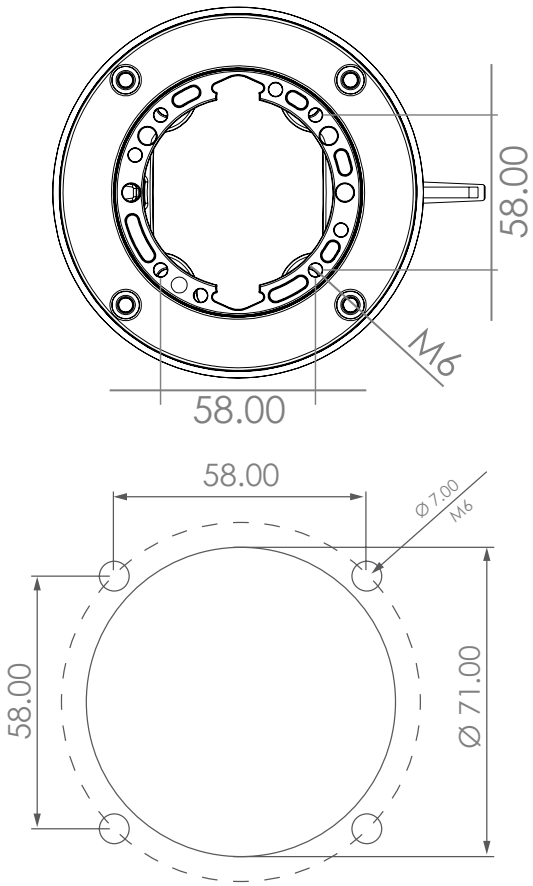

Weight	1300 gr
Color Ral No	RAL 7035
Package	1
Package Dimension	150x60x145 mm
Material	Aluminum
Movement	Rotatable 315°
Diameter	Ø133 mm

ARM130.400

Rotatable Panel 90°Angle Coupling



ARM130.400 Rotatable Panel 90° Angle Coupling is suitable for an operator panel that requires positioning directly after a 90° angel corner turn. The rotation angle is 315° in total. The ability to rotate around itself provides flexibility for the operator using the panel in bringing it to a desired position. ARM130.400 is an ideal product that will be used for the panel types with more depth.

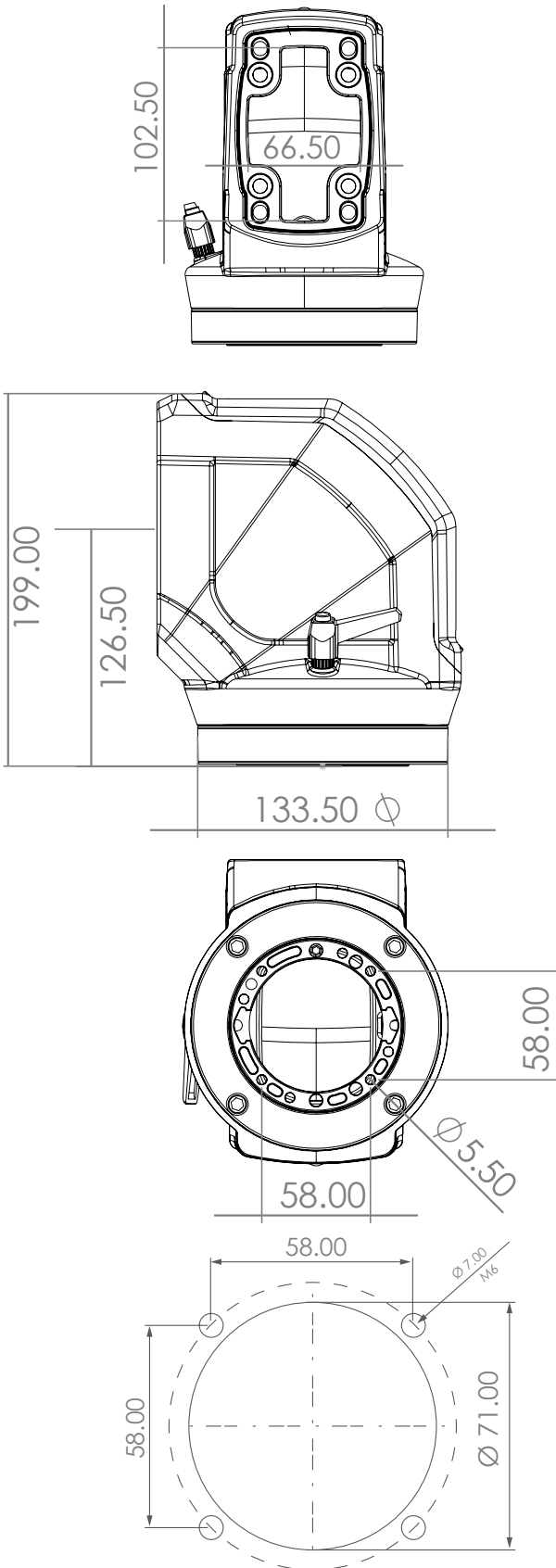

Weight	2400 gr
Color Ral No	RAL 7035 (Cover RAL 7016)
Package	1
Package Dimension	220x150x170 mm
Material	Aluminum
Movement	Rotatable 315°
Diameter	Ø133,5 mm

90° Angle Piece **ARM130.420**

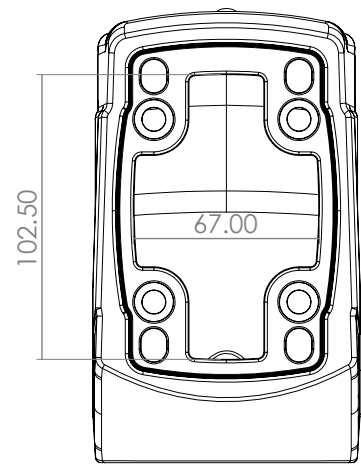

ARM130.420 90° Angle Piece is a fixed corner module that connects the operator arms in horizontal and vertical axis. Based on the structural features and usage conditions, this product can be used for heavy loads panels positioned in long distance and without any compatibility issues.

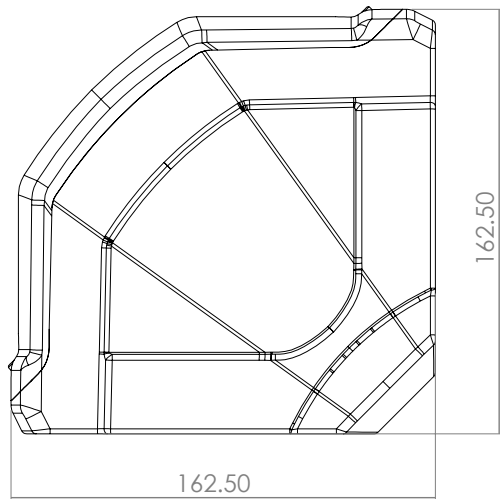

Weight	1650 gr
Color Ral No	RAL 7035 (Cover RAL 7016)
Package	1
Package Dimension	170x100x160 mm
Material	Aluminum
Movement	Fixed

ARM130.500 Rotatable Intermediate Hinge



ARM130.500 Rotatable Intermediate Hinge module is used to ensure two operator arms on the horizontal axis are mounted on the assembly point and move at a semi-independent angel (315°) from each other. This product is an indispensable product for heavy loads and long lenght configurations in terms of structure and usage.

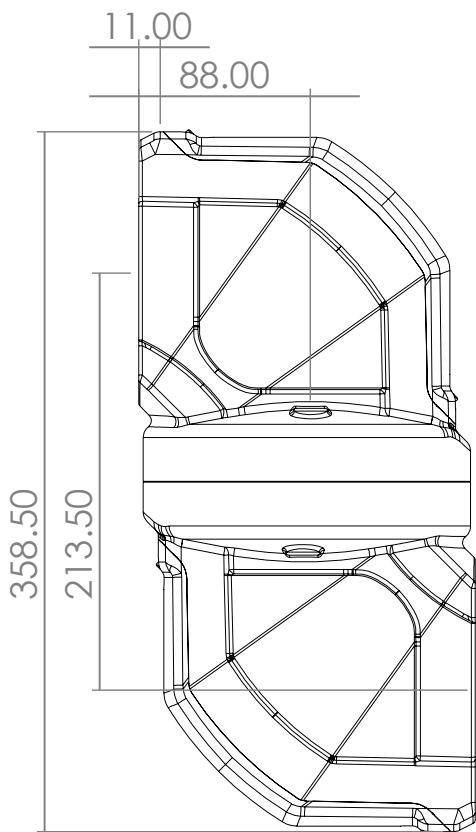
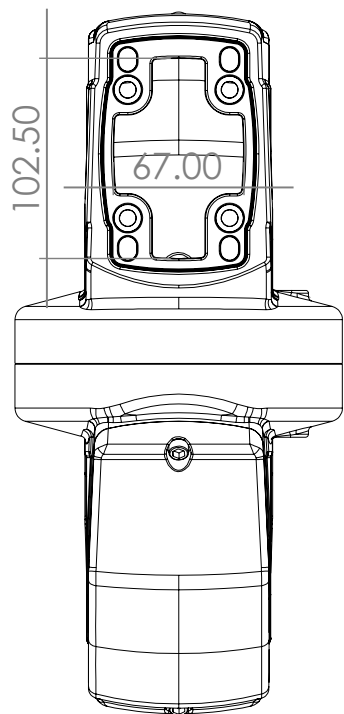

Weight	5700 gr
Color Ral No	RAL 7035 (Cover RAL 7016)
Package	1
Package Dimension	355x180x175 mm
Material	Aluminum
Movement	Rotatable 315°

Steel Interconnection Module -
With Bellows

ARM130.505

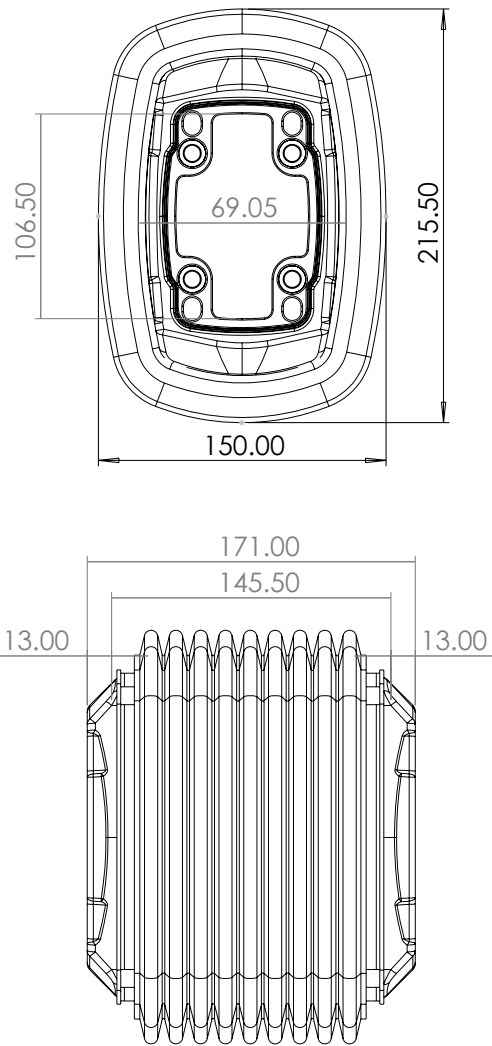

ARM130.505 Steel Interconnection Module - With Bellows is used to mount two operator arms to the connection points horizontally enabling them to move at 90° to the right or 90° to the left. The cast steel body of this product safely combines heavy and long arm configurations.

Weight	1000 gr
Color Ral No	RAL 7035 (Bellow RAL 7016)
Package	1
Package Dimension	245x180x160 mm
Material	Steel Casting
Movement	Right 90° / Left 90°

ARM130.600

Rotatable Top Mounted 90° Angle Joint



ARM130.600 Rotatable Top Mounted 90° Angle Joint is produced to provide a connection for a high position point. It allows a smooth rotation for the panel horizontally and provides a 315° movement mobility to the right or left. This product is designated for configurations with a heavy loads.

Weight	5900 gr
Color Ral No	RAL 7035 (Cover RAL 7016)
Package	1
Package Dimension	210x240x220 mm
Material	Aluminum
Movement	Rotatable 315°

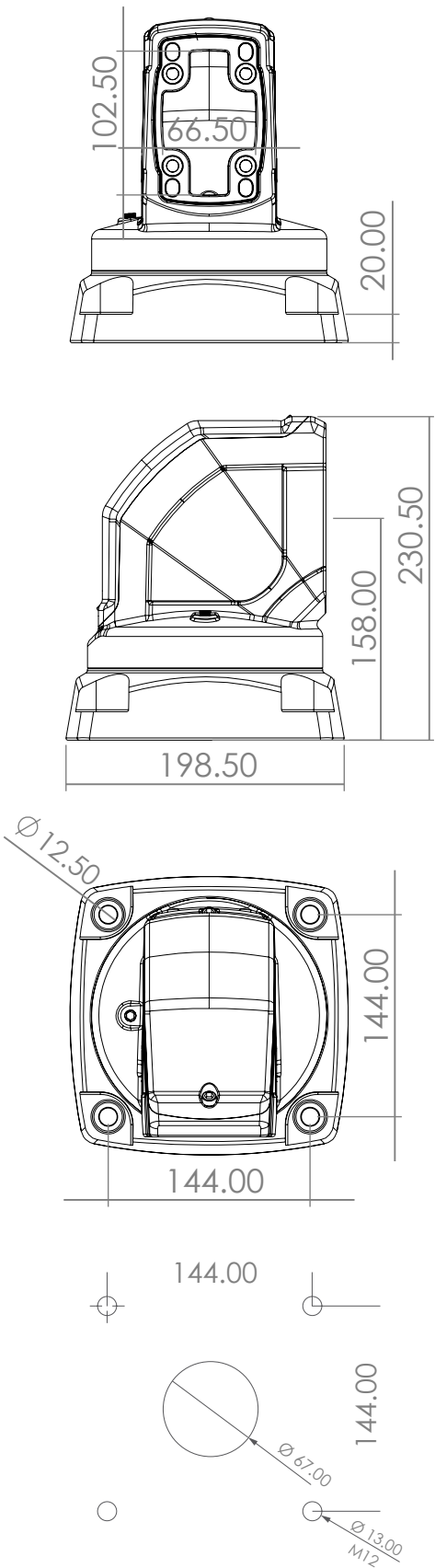

Rotatable Top Mounted Vertical Outlet

ARM130.610

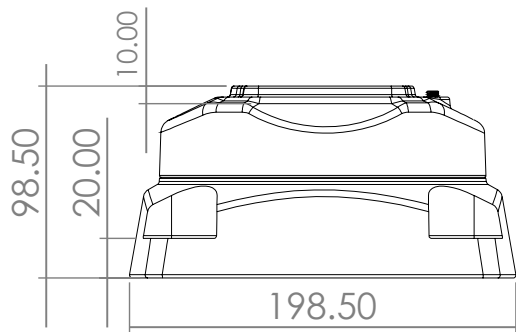
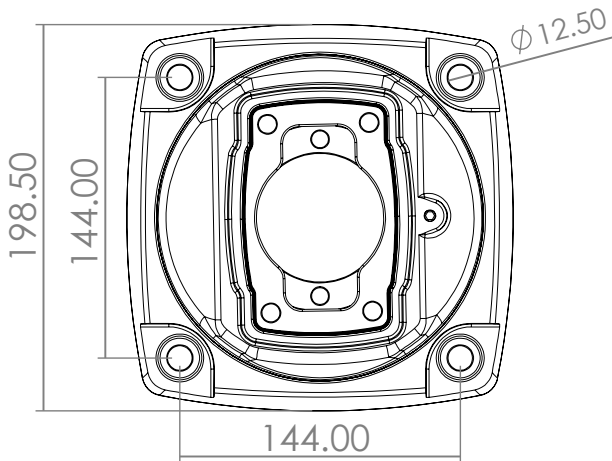

ARM130.610 Rotatable Top Mounted Vertical Outlet provides a 315° rotation movement to the right and left. It is designated for heavy loads configurations and can also serve as a "Fixed Kiosk"

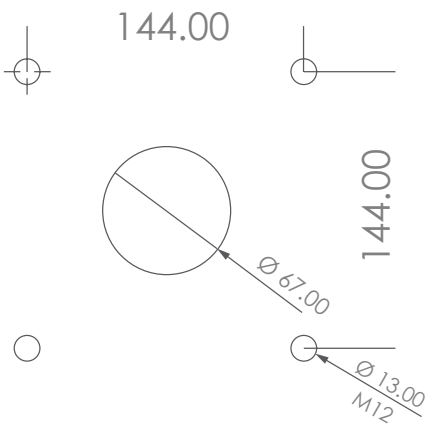

Weight	4800 gr
Color Ral No	RAL 7035 (Cover RAL 7016)
Package	1
Package Dimension	220x125x205 mm
Material	Aluminum
Movement	Rotatable 315°

ARM130.700

Rotatable Wall-Mounted Hinge Horizontal Outlet

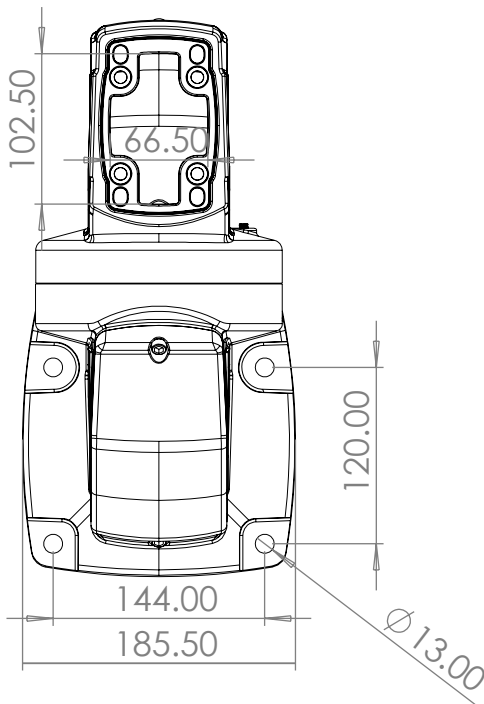

ARM130.700 Rotatable Wall-Mounted Hinge Horizontal Outlet is designed to create a connection point to any preferred point where it is unavailable on the ground. It allows the operator arm to move at a 315° left and right horizontally for heavy loads configurations.

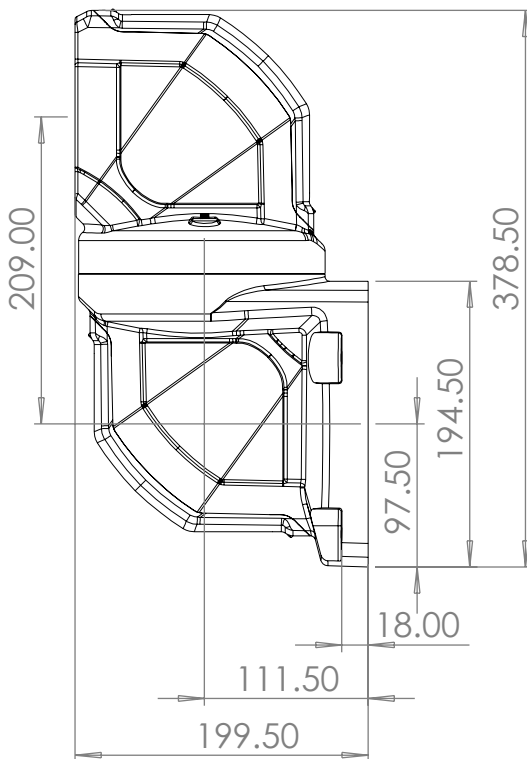

Weight	6500 gr
Color Ral No	RAL 7035 (Cover RAL 7016)
Package	1
Package Dimension	390x200x210 mm
Material	Aluminum
Movement	Rotatable 315°

Steel Wall Mounted Module -
With Bellows

ARM130.705

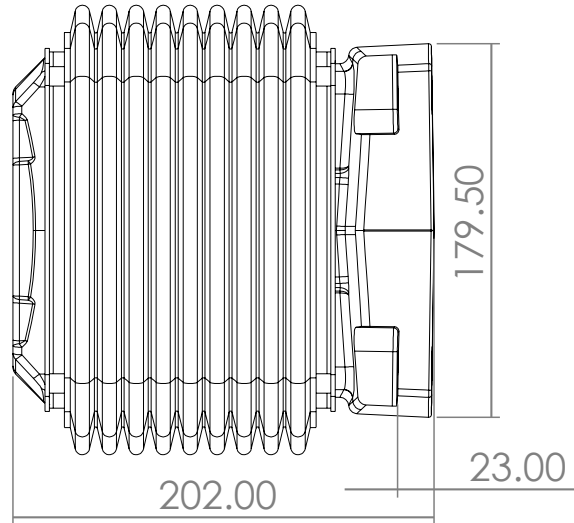
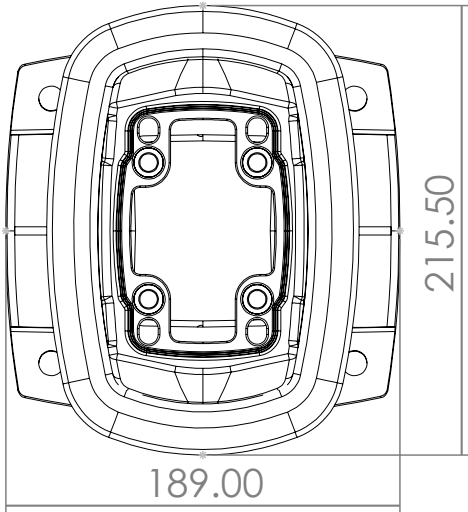

The Steel Wall-Mounted Module - With Bellows helps fixing the operator arms horizontally which are positioned on vertical surfaces. This product with its cast steel body gives reliability for heavy loads and long-distance arm configurations. It allows a mobility of 90° to the right and left.

Weight	1000 gr
Color Ral No	RAL 7035 (Bellow RAL 7016)
Package	1
Package Dimension	250x220x290 mm
Material	Aluminum
Movement	Right 90° / Left 90°

ARM130.710

Rotatable Wall-Mounted Hinge
Vertical Outlet



ARM130.710 Rotatable Wall-Mounted Hinge Vertical Outlet is designed to create a connection point to any preferred point vertically. It allows the operator arm to move at a 315° left and right fo heavy loads configurations.

Weight	5750 gr
Color Ral No	RAL 7035 (Cover RAL 7016)
Package	1
Package Dimension	280x200x210 mm
Material	Aluminum
Movement	Rotatable 315°

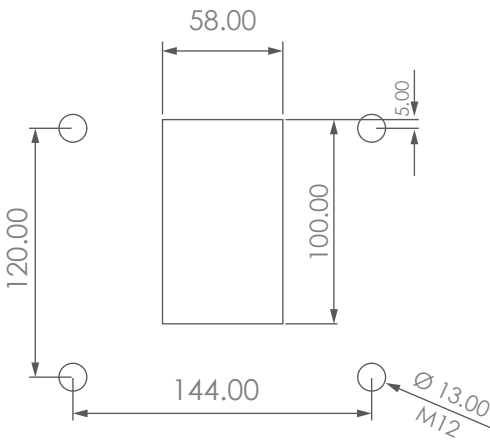
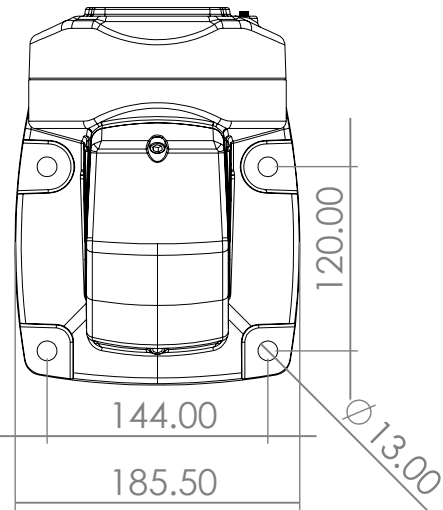
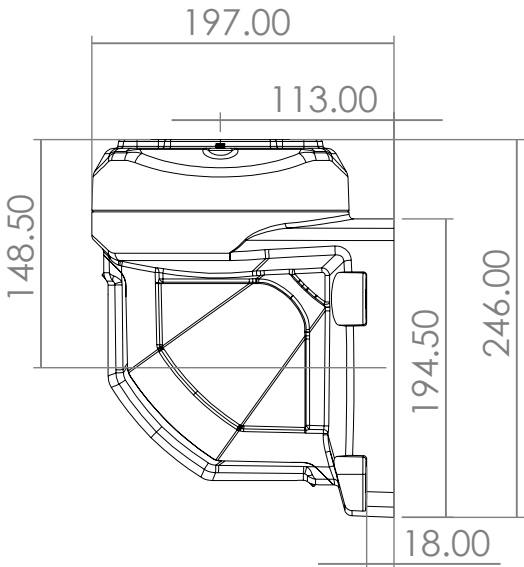

Wall-Socket Mounting Bracket

ARM130.800

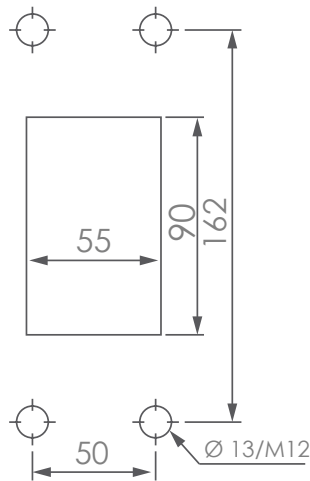
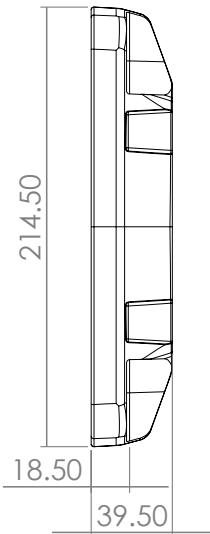
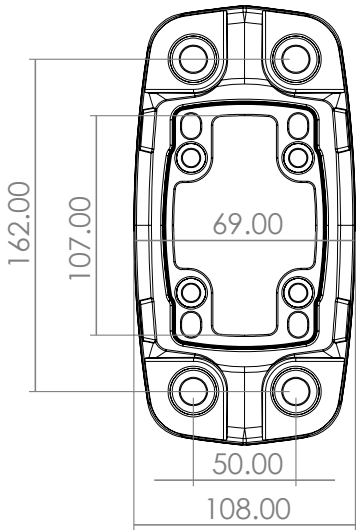

ARM130.800 Wall-Socket Mounting Bracket is a fixed connection that can be easily connected to vertical and horizontal surfaces. It is produced for heavy loads configurations.

Weight	1000 gr
Color Ral No	RAL 7035 (Cover RAL 7016)
Package	1
Package Dimension	220x50x110 mm
Material	Aluminum
Movement	Fixed

ARM130.810

Warning Lamp Cover (M22)



ARM130.810 Warning Lamp Cover (M22) is placed on the corner module ensuring an area for the warning lamp to be placed. The warning lamp connection diameter is M22x1.5

Weight	290 gr
Color Ral No	RAL 7016
Package	1
Package Dimension	200x55x100 mm
Material	Aluminum
Movement	Fixed M22

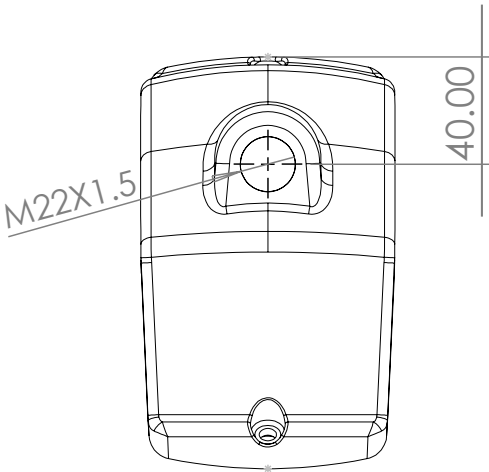
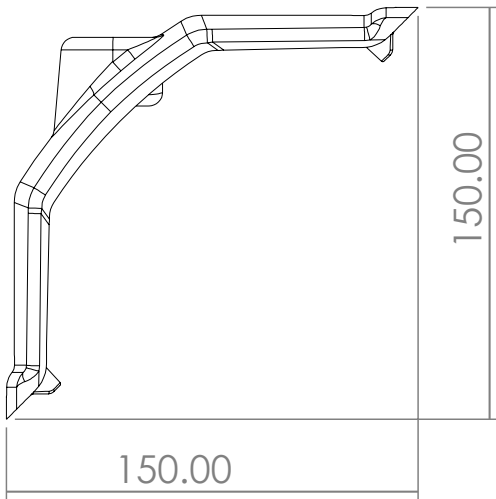
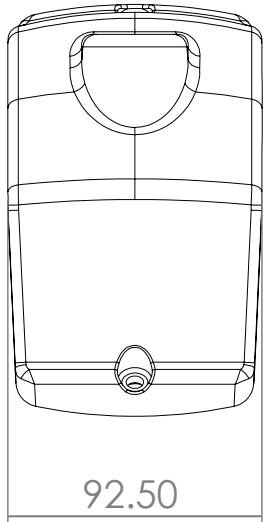

Warning Lamp Cover (M18)

ARM130.811

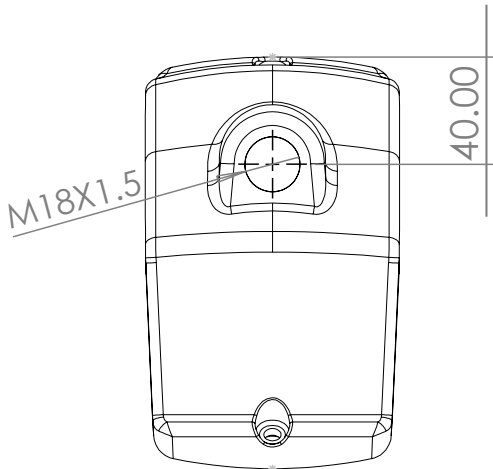
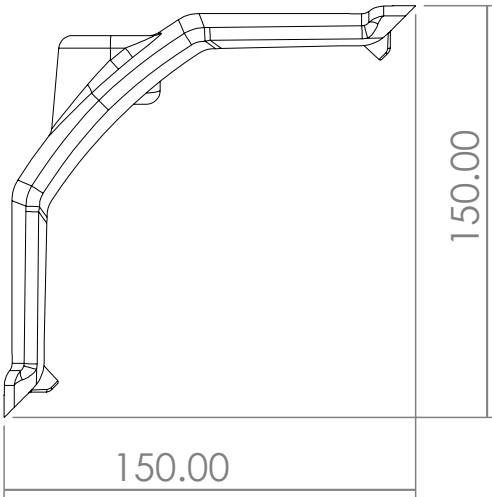
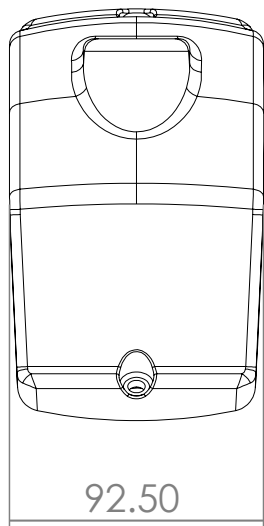

ARM130.811 Warning Lamp Cover (M18) is placed on the corner module ensuring an area for the warning lamp to be placed. The warning lamp connection diameter is M18×1.5

Weight	290 gr
Color Ral No	RAL 7016
Package	1
Package Dimension	200x55x100 mm
Material	Aluminum
Movement	Fixed M18

ARM130.820

130/080 Support Arm Adaptor

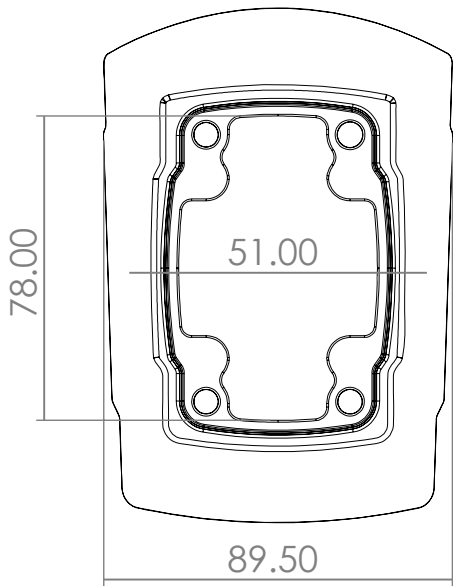

130/080 Support Arm Adaptor is used to secure the connection between ARM130 and ARM080 Its is designed for configurations of heavy loads. The configurations with this product prevent vibrating and sagging as a result of heavy loads. This support Arm Adaptor can be used horizontally or vertically.

Weight	500 gr
Color Ral No	RAL 7035
Package	1
Package Dimension	140x70x90 mm
Material	Aluminum
Movement	Fixed

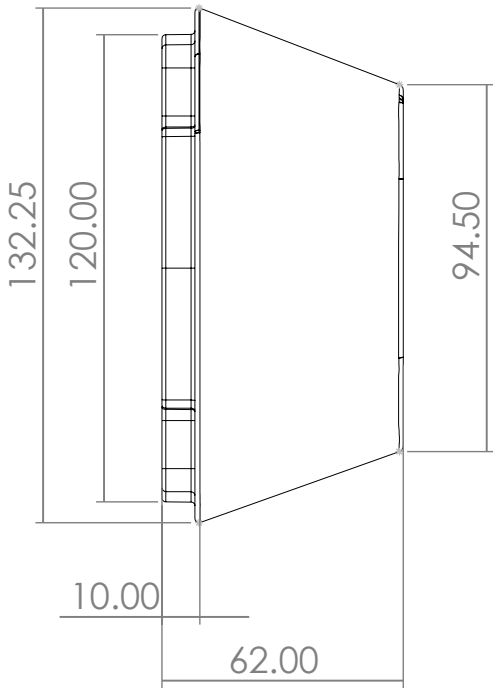

Rotatable Panel 90°Angle
Coupling

ARM130.550

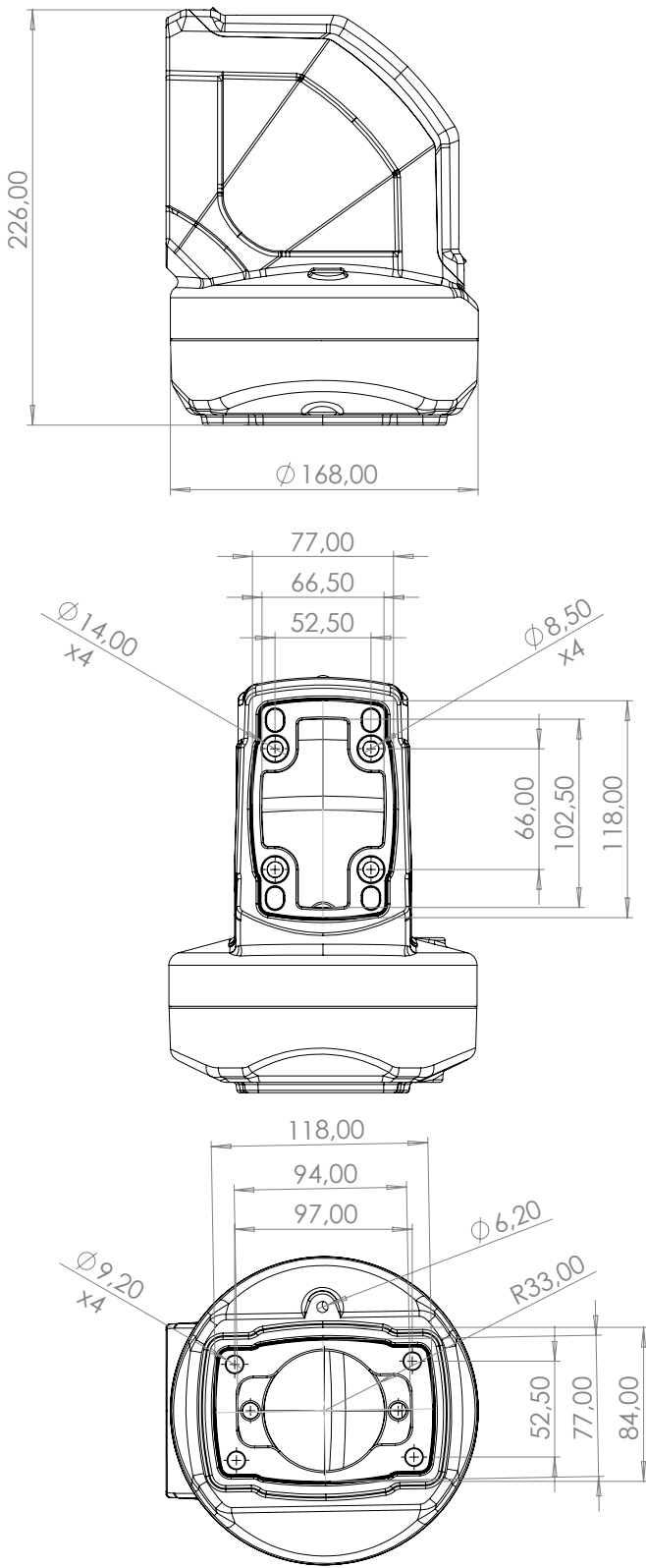

ARM130.550 Rotatable Panel 90° Angle Coupling is suitable for an operator panel that requires positioning directly after a 90° angel corner turn. Max. diameter is 123mm and the rotation angle is 315° in total. The ability to rotate around itself provides flexibility for the operator using the panel in bringing it to a desired position. ARM130.550 is an ideal product that will be used for the panel types with more depth.

Weight	1780 gr
Color Ral No	RAL 7035 / Cover RAL 7016
Package	1
Package Dimension	150x160x140 mm
Material	Aluminum
Movement	Rotatable 315°
Diameter	Ø123 mm

