

FS series Magnetic reed switch

- ① Flexible material
- ② Impact-resistant engineering material
- ③ Special material to enhance product flexibility
- ④ The FS series includes four types of switches: H, E, G and J.

It features new IP66 protection and an oil-resistant design, which can be applied to various cylinders.

Two types of switches cross-sectional shapes:



Code Explanation

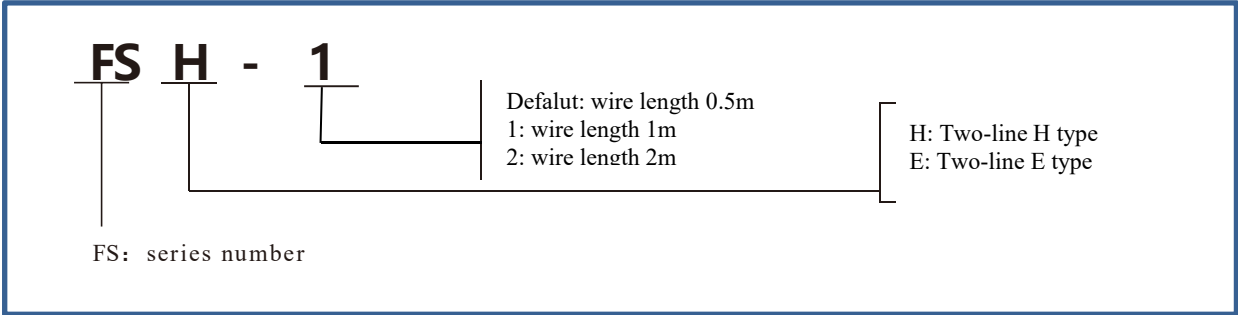

***LMC25-32: use FSH type; LMC40-80 use FSE type.**

Technical data

Switch type	Two line type
Working voltage	10-28V DC
Working current	2.5-50mA
Working voltage drop	2.65V Max
Leakage current	90 μA Max
Inductive sensitivity	40Gauss
Indicator light	Red LED
Wire specification	Φ2.8, Grey oil-resistant PVC, wire can withstand bending more than 200,000 times
Working temperature	-10~70℃
Storage temperature	-20~80℃
Protection level	IP66
Impact resistance	50G
Vibration resistance	9G

Dimension

FSH

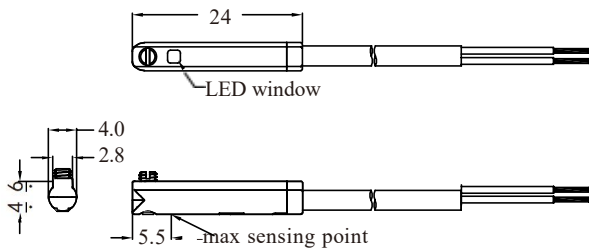

FSE

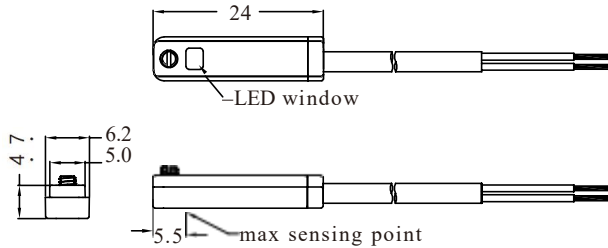

wiring diagram

1. Common wiring methods:

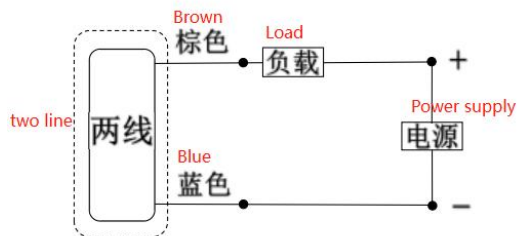

2. Series connection method

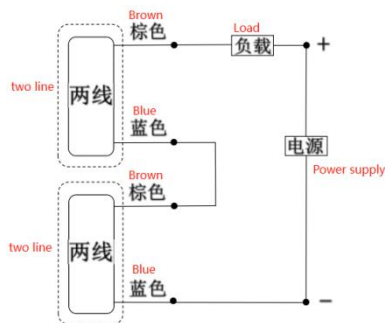

3. Parallel connection method

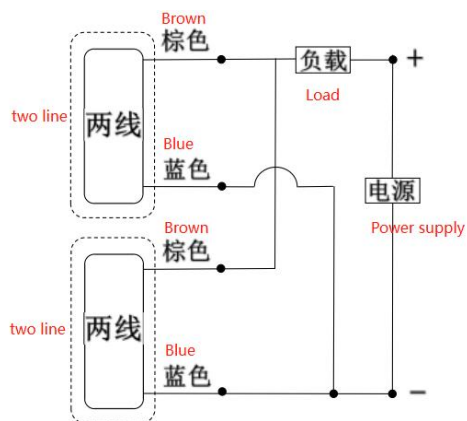

FSH series assembly

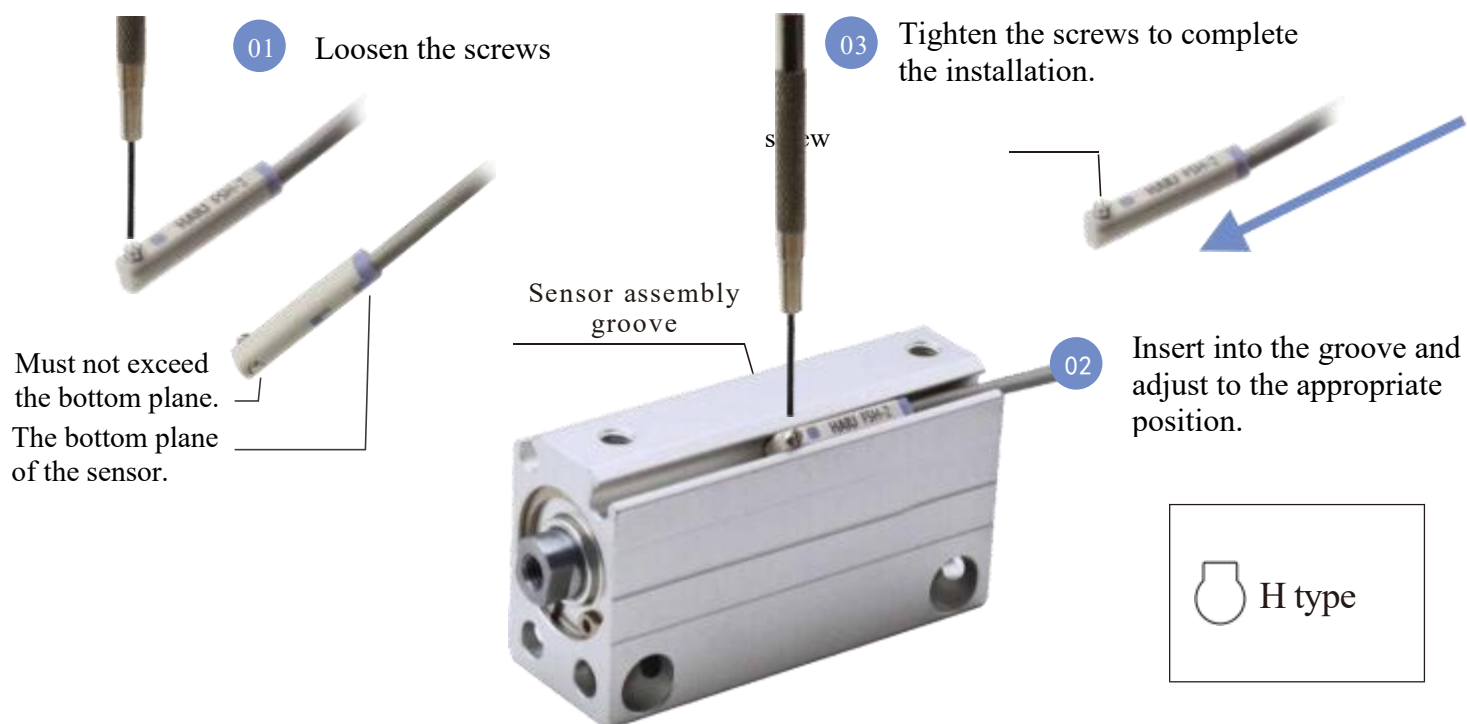

FSE series assembly

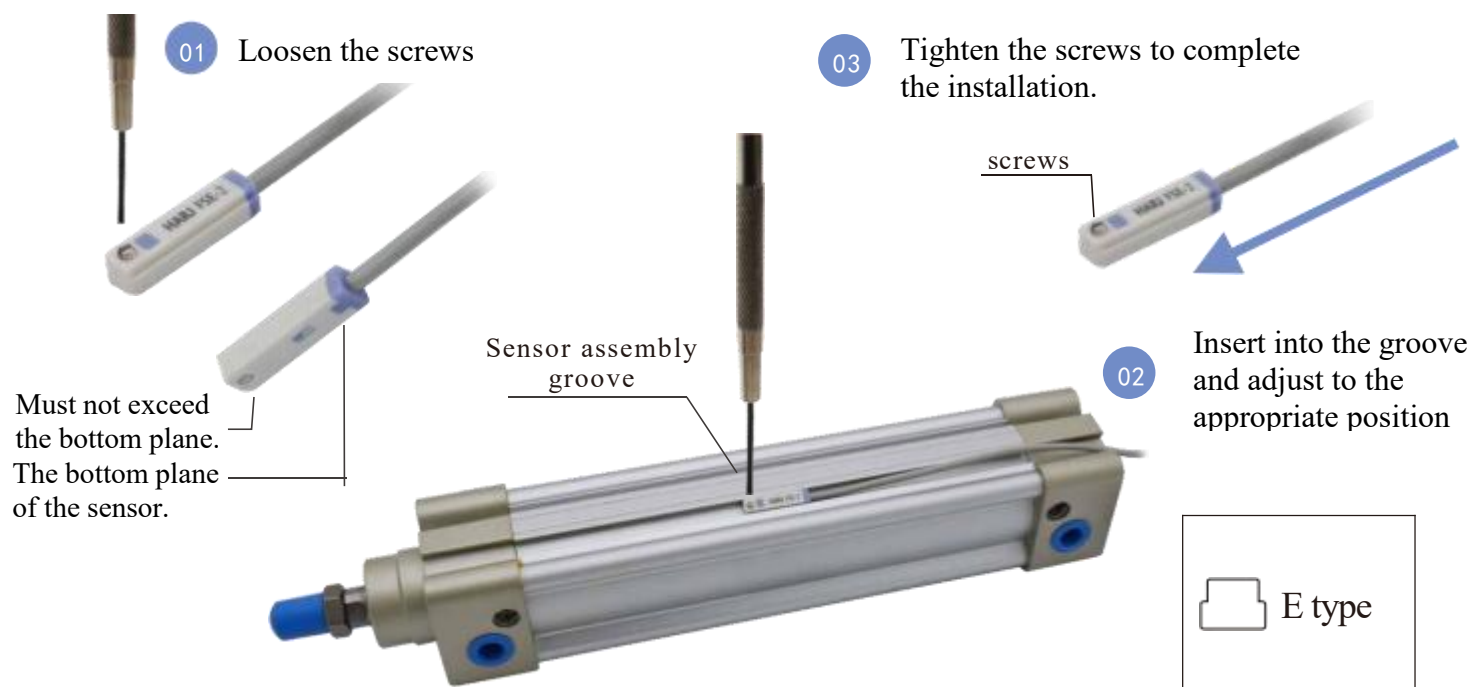

Attention

1. The switch must be connected to the load before being powered on; otherwise, it may be damaged.
2. During use, try to stay away from strong magnetic fields or environments with iron objects nearby to avoid interference.
3. When the load is an inductive load such as a relay or solenoid valve, a 1N4001 diode must be connected in parallel across the load.
4. When the load is a capacitive load or the length of the switch wire exceeds 10 meters, an inductor with a value of 470UH - 2000UH should be connected in series near the switch.

