

Material:

Polyethylene UHMW-PE with molecular density 5,600,000 g/mol
 Linear expansion coefficient: $1.1 \times 10^{-4} \text{ } ^\circ\text{F}^{-1}$ ($2 \times 10^{-4} \text{ } ^\circ\text{C}^{-1}$)
 Operating temperature: -40 to 176°F (-40 to +80°C)

1038 Profilo "L" L-Profile / L-Profil

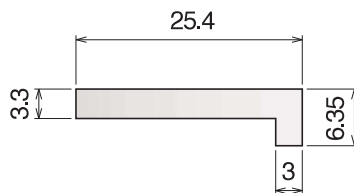
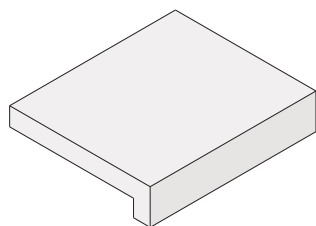

Part	Article-Nr.	L	Colour	Availability
1038	103803	60 m	white	On request

NORTH AMERICA STANDARD



150 Profilo "L" L-Profile / L-Profil

On request available in white color

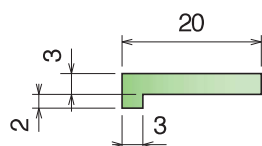
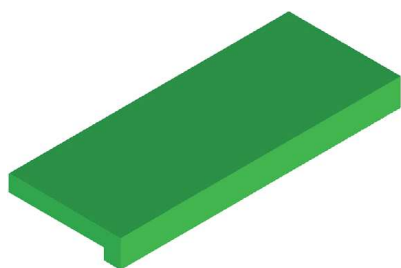

Part	Article-Nr.	Colour	Availability
150	15001	black	Stock item
150	15002	green	Stock item



1058 Profilo "L" L-Profile / L-Profil

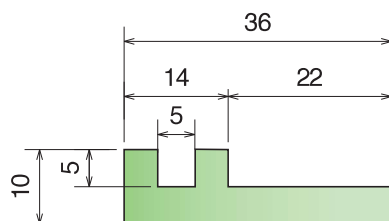
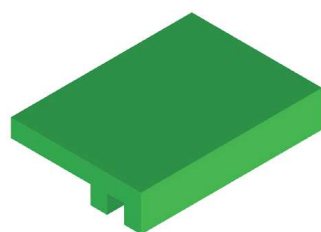

Part	Article-Nr.	L	Colour	Availability
1058	105801C	3 m	black	Stock item
1058	105801	6 m	black	On request
1058	105802C	3 m	green	Stock item
1058	105802	6 m	green	On request

174 Profilo "L" L-Profile / L-Profil

On request available in white color

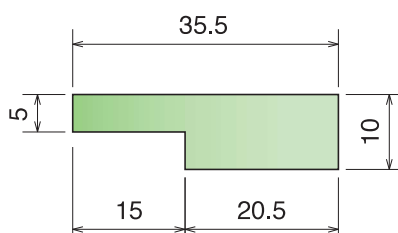
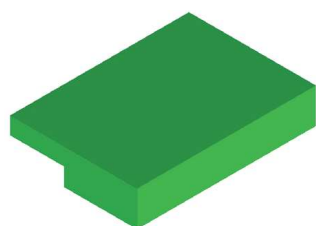

Part	Article-Nr.	L	Colour	Availability
174	17401C	3 m	black	Stock item
174	17401	6 m	black	On request
174	17402C	3 m	green	Stock item
174	17402	6 m	green	On request

